

**SILVERTHIN SA070CP0****7 in Open Type C Thin Section Bearing****Specifications**

Bore (B)	7.000 in
Outside Diameter (D)	7.500 in
Width	1/4"
Land Diameter (L <sub>1</sub> )	7.186 in
Land Diameter (L <sub>2</sub> )	7.314 in
Approximate Weight	0.31 lbs
Separator	Brass; snapover separator
Precision Class	ABEC Class 1
Bearing Type	Radial Contact (Type C)
Seals, Shields	None (Open)
Unit System	Inch

**Load Capacities**

Static Radial Load	2,200 lbf
Dynamic Radial Load	785 lbf

**Interchange**

Silverthin	SA070CP0	Kaydon	KA070CP0	Kaydon	KA070CP0	INA	CSCA070
SKF	FPCA700	FAG	L10QA700	NSK	NBC17706	NTN	KRA070
SSB	RA070CP0	RBC	KA070CP0*RBC				

**Brass; snapover separator**

1/8" balls

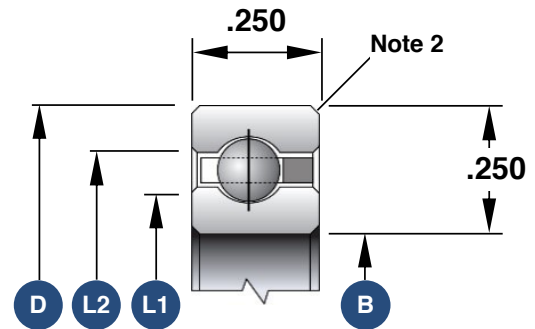

1. Load capacities are not additive
2. The maximum shaft or housing fillet radius that the bearing corners will clear for this series is 0.025"
3. Race Width Tolerance: +0.000 -0.005"

**Also Available**

Open Angular Contact	SA070ARO
Open 4-Point Contact	SA070XPO
Open Duplexed (Back-to-Back)	SA070BR0
Open Duplexed (Face-to-Face)	SA070FR0