

SILVERTHIN SA070XP0**7 in Open Type X Thin Section Bearing****Specifications**

Bore (B)	7.000 in
Outside Diameter (D)	7.500 in
Width	1/4"
Land Diameter (L ₁)	7.186 in
Land Diameter (L ₂)	7.314 in
Approximate Weight	0.31 lbs
Separator	Brass; snapover separator
Precision Class	ABEC Class 1
Bearing Type	4-Point Contact (Type X)
Seals, Shields	None (Open)
Unit System	Inch

Load Capacities

Static Radial Load	2,200 lbf
Dynamic Radial Load	1,045 lbf
Static Thrust Load	5,500 lbf
Dynamic Thrust Load	1,730 lbf
Static Moment Load	7,980 in-lbs
Dynamic Moment Load	2,845 in-lbs

Interchange

Silverthin	SA070XP0	Kaydon	KA070XP0	Kaydon	KA070XP0	INA	CSXA070
SKF	FPXA700	FAG	L18QA700	NSK	NBX17706	NTN	KXA070
SSB	RA070XP0	RBC	KA070XP0*RBC				

Brass; snapover separator

1/8" balls

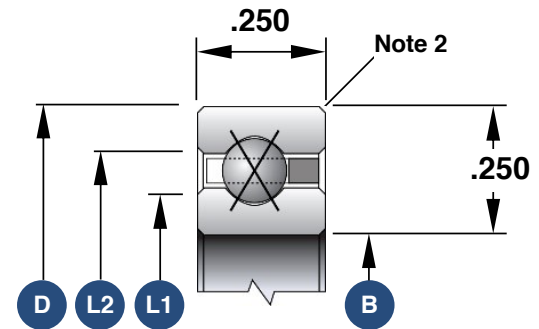

1. Load capacities are not additive
2. The maximum shaft or housing fillet radius that the bearing corners will clear for this series is 0.025"
3. Race Width Tolerance: +0.000 -0.005"

Also Available

Open Angular Contact	SA070ARO
Open Radial Contact	SA070CPO
Open Duplexed (Back-to-Back)	SA070BR0
Open Duplexed (Face-to-Face)	SA070FR0