

SILVERTHIN SA075AR0**7.5 in Open Type A Thin Section Bearing****Specifications**

Bore (B)	7.500 in
Outside Diameter (D)	8.000 in
Width	1/4"
Land Diameter (L ₁)	7.686 in
Land Diameter (L ₂)	7.814 in
Land Diameter (L ₃)	7.861 in
Approximate Weight	0.34 lbs
Separator	Brass; one piece pocket separator
Precision Class	ABEC Class 1
Bearing Type	Angular Contact (Type A)
Seals, Shields	None (Open)
Unit System	Inch

Load Capacities

Static Radial Load	2,720 lbf
Dynamic Radial Load	855 lbf
Static Thrust Load	7,840 lbf
Dynamic Thrust Load	2,190 lbf

Interchange

Silverthin	SA075AR0	Kaydon	KA075AR0
SKF	FPAA708	FAG	L15QA708
SSB	RA075AR0	RBC	KA075AR0*RBC

Brass; one piece pocket separator

1/8" balls

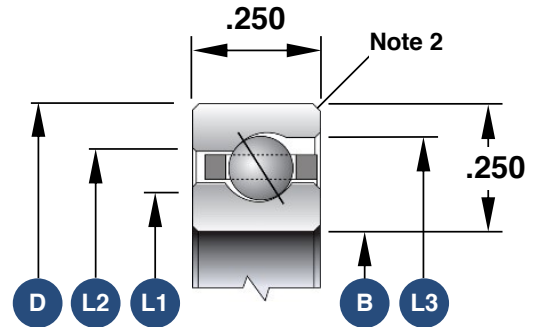

1. Load capacities are not additive
2. The maximum shaft or housing fillet radius that the bearing corners will clear for this series is 0.025"
3. Race Width Tolerance: +0.000 -0.005"

Also Available

Open Radial Contact	SA075CP0
Open 4-Point Contact	SA075XP0
Open Duplexed (Back-to-Back)	SA075BR0
Open Duplexed (Face-to-Face)	SA075FR0