

SILVERTHIN SA075CP0**7.5 in Open Type C Thin Section Bearing****Specifications**

Bore (B)	7.500 in
Outside Diameter (D)	8.000 in
Width	1/4"
Land Diameter (L ₁)	7.686 in
Land Diameter (L ₂)	7.814 in
Approximate Weight	0.34 lbs
Separator	Brass; snapover separator
Precision Class	ABEC Class 1
Bearing Type	Radial Contact (Type C)
Seals, Shields	None (Open)
Unit System	Inch

Load Capacities

Static Radial Load	2,350 lbf
Dynamic Radial Load	820 lbf

Interchange

Silverthin	SA075CP0	Kaydon	KA075CP0	Kaydon	KA075CP0	INA	CSCA075
SKF	FPCA708	FAG	L10QA708	NSK	NBC19006	NTN	KRA075
SSB	RA075CP0	RBC	KA075CP0*RBC				

Brass; snapover separator

1/8" balls

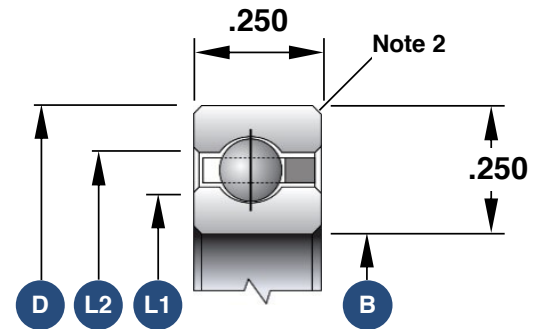

1. Load capacities are not additive
2. The maximum shaft or housing fillet radius that the bearing corners will clear for this series is 0.025"
3. Race Width Tolerance: +0.000 -0.005"

Also Available

Open Angular Contact	SA075AR0
Open 4-Point Contact	SA075XP0
Open Duplexed (Back-to-Back)	SA075BR0
Open Duplexed (Face-to-Face)	SA075FR0