

SILVERTHIN SA075XP0**7.5 in Open Type X Thin Section Bearing****Specifications**

| | |
|---------------------------------|---------------------------|
| Bore (B) | 7.500 in |
| Outside Diameter (D) | 8.000 in |
| Width | 1/4" |
| Land Diameter (L ₁) | 7.686 in |
| Land Diameter (L ₂) | 7.814 in |
| Approximate Weight | 0.34 lbs |
| Separator | Brass; snapover separator |
| Precision Class | ABEC Class 1 |
| Bearing Type | 4-Point Contact (Type X) |
| Seals, Shields | None (Open) |
| Unit System | Inch |

Load Capacities

| | |
|---------------------|--------------|
| Static Radial Load | 2,350 lbf |
| Dynamic Radial Load | 1,090 lbf |
| Static Thrust Load | 5,880 lbf |
| Dynamic Thrust Load | 1,810 lbf |
| Static Moment Load | 9,120 in-lbs |
| Dynamic Moment Load | 3,165 in-lbs |

Interchange

| | | | | | | | |
|------------|--------------------------|--------|------------------------------|--------|--------------------------|-----|-------------------------|
| Silverthin | SA075XP0 | Kaydon | KA075XP0 | Kaydon | KA075XP0 | INA | CSXA075 |
| SKF | FPXA708 | FAG | L18QA708 | NSK | NBX19006 | NTN | KXA075 |
| SSB | RA075XP0 | RBC | KA075XP0*RBC | | | | |

Brass; snapover separator

1/8" balls

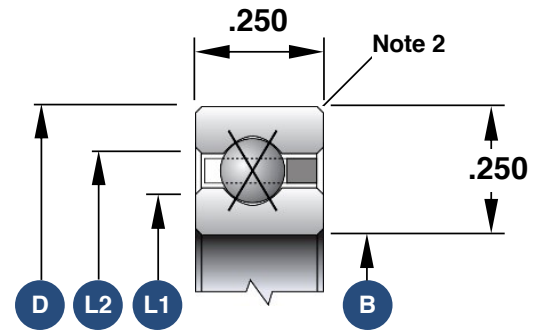

1. Load capacities are not additive
2. The maximum shaft or housing fillet radius that the bearing corners will clear for this series is 0.025"
3. Race Width Tolerance: +0.000 -0.005"

Also Available

| | |
|------------------------------|--------------------------|
| Open Angular Contact | SA075AR0 |
| Open Radial Contact | SA075CP0 |
| Open Duplexed (Back-to-Back) | SA075BR0 |
| Open Duplexed (Face-to-Face) | SA075FR0 |