

SILVERTHIN SA080CP0**8 in Open Type C Thin Section Bearing****Specifications**

Bore (B)	8.000 in
Outside Diameter (D)	8.500 in
Width	1/4"
Land Diameter (L ₁)	8.186 in
Land Diameter (L ₂)	8.314 in
Approximate Weight	0.38 lbs
Separator	Brass; snapover separator
Precision Class	ABEC Class 1
Bearing Type	Radial Contact (Type C)
Seals, Shields	None (Open)
Unit System	Inch

Load Capacities

Static Radial Load	2,500 lbf
Dynamic Radial Load	850 lbf

Interchange

Silverthin	SA080CP0	Kaydon	KA080CP0	Kaydon	KA080CP0	INA	CSCA080
SKF	FPCA800	FAG	L10QA800	NSK	NBC20306	NTN	KRA080
SSB	RA080CP0	RBC	KA080CP0*RBC				

Brass; snapover separator

1/8" balls

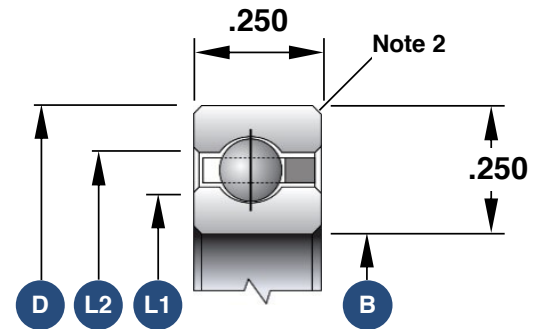

1. Load capacities are not additive
2. The maximum shaft or housing fillet radius that the bearing corners will clear for this series is 0.025"
3. Race Width Tolerance: +0.000 -0.005"

Also Available

Open Angular Contact	SA080ARO
Open 4-Point Contact	SA080XPO
Open Duplexed (Back-to-Back)	SA080BRO
Open Duplexed (Face-to-Face)	SA080FRO