

SILVERTHIN SA080XPO**8 in Open Type X Thin Section Bearing****Specifications**

Bore (B)	8.000 in
Outside Diameter (D)	8.500 in
Width	1/4"
Land Diameter (L ₁)	8.186 in
Land Diameter (L ₂)	8.314 in
Approximate Weight	0.38 lbs
Separator	Brass; snapover separator
Precision Class	ABEC Class 1
Bearing Type	4-Point Contact (Type X)
Seals, Shields	None (Open)
Unit System	Inch

Load Capacities

Static Radial Load	2,500 lbf
Dynamic Radial Load	1,130 lbf
Static Thrust Load	6,260 lbf
Dynamic Thrust Load	1,890 lbf
Static Moment Load	10,330 in-lbs
Dynamic Moment Load	3,500 in-lbs

Interchange

Silverthin	SA080XPO	Kaydon	KA080XPO	Kaydon	KA080XPO	INA	CSXA080
SKF	FPXA800	FAG	L18QA800	NSK	NBX20306	NTN	KXA080
SSB	RA080XPO	RBC	KA080XPO*RBC				

Brass; snapover separator

1/8" balls

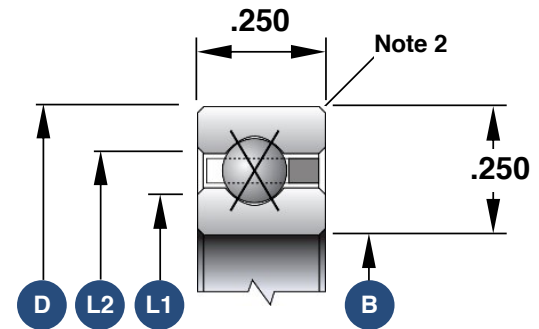

1. Load capacities are not additive
2. The maximum shaft or housing fillet radius that the bearing corners will clear for this series is 0.025"
3. Race Width Tolerance: +0.000 -0.005"

Also Available

Open Angular Contact	SA080ARO
Open Radial Contact	SA080CPO
Open Duplexed (Back-to-Back)	SA080BRO
Open Duplexed (Face-to-Face)	SA080FRO