

**SILVERTHIN SA090AR0****9 in Open Type A Thin Section Bearing****Specifications**

Bore (B)	9.000 in
Outside Diameter (D)	9.500 in
Width	1/4"
Land Diameter (L <sub>1</sub> )	9.186 in
Land Diameter (L <sub>2</sub> )	9.314 in
Land Diameter (L <sub>3</sub> )	9.357 in
Approximate Weight	0.44 lbs
Separator	Brass; one piece pocket separator
Precision Class	ABEC Class 1
Bearing Type	Angular Contact (Type A)
Seals, Shields	None (Open)
Unit System	Inch

**Load Capacities**

Static Radial Load	3,240 lbf
Dynamic Radial Load	955 lbf
Static Thrust Load	9,360 lbf
Dynamic Thrust Load	2,470 lbf

**Interchange**

Silverthin	<a href="#">SA090AR0</a>	Kaydon	<a href="#">KA090AR0</a>
SKF	<a href="#">FPAA900</a>	FAG	<a href="#">L15QA900</a>
SSB	<a href="#">RA090AR0</a>	RBC	<a href="#">KA090AR0*RBC</a>

**Brass; one piece pocket separator**

1/8" balls

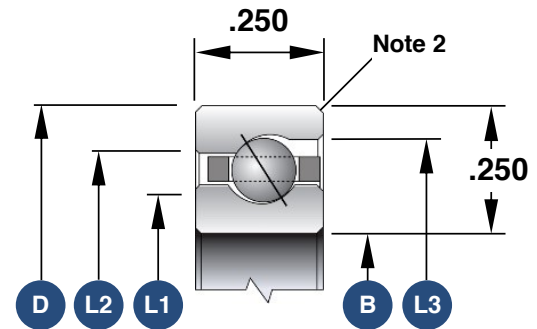

1. Load capacities are not additive
2. The maximum shaft or housing fillet radius that the bearing corners will clear for this series is 0.025"
3. Race Width Tolerance: +0.000 -0.005"

**Also Available**

Open Radial Contact	<a href="#">SA090CP0</a>
Open 4-Point Contact	<a href="#">SA090XP0</a>
Open Duplexed (Back-to-Back)	<a href="#">SA090BR0</a>
Open Duplexed (Face-to-Face)	<a href="#">SA090FR0</a>