

**SILVERTHIN SA090CP0****9 in Open Type C Thin Section Bearing****Specifications**

Bore (B)	9.000 in
Outside Diameter (D)	9.500 in
Width	1/4"
Land Diameter (L <sub>1</sub> )	9.186 in
Land Diameter (L <sub>2</sub> )	9.314 in
Approximate Weight	0.44 lbs
Separator	Brass; snapover separator
Precision Class	ABEC Class 1
Bearing Type	Radial Contact (Type C)
Seals, Shields	None (Open)
Unit System	Inch

**Load Capacities**

Static Radial Load	2,810 lbf
Dynamic Radial Load	910 lbf

**Interchange**

Silverthin	<a href="#">SA090CP0</a>	Kaydon	<a href="#">KA090CP0</a>	Kaydon	<a href="#">KA090CP0</a>	INA	<a href="#">CSCA090</a>
SKF	<a href="#">FPCA900</a>	FAG	<a href="#">L10QA900</a>	NSK	<a href="#">NBC22806</a>	NTN	<a href="#">KRA090</a>
SSB	<a href="#">RA090CP0</a>	RBC	<a href="#">KA090CP0*RBC</a>				

**Brass; snapover separator**

1/8" balls

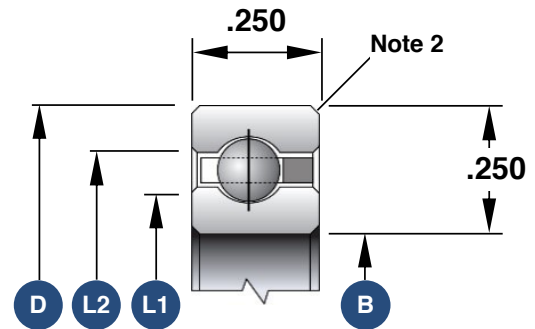

1. Load capacities are not additive
2. The maximum shaft or housing fillet radius that the bearing corners will clear for this series is 0.025"
3. Race Width Tolerance: +0.000 -0.005"

**Also Available**

Open Angular Contact	<a href="#">SA090ARO</a>
Open 4-Point Contact	<a href="#">SA090XPO</a>
Open Duplexed (Back-to-Back)	<a href="#">SA090BRO</a>
Open Duplexed (Face-to-Face)	<a href="#">SA090FRO</a>