

SILVERTHIN SA090XPO**9 in Open Type X Thin Section Bearing****Specifications**

Bore (B)	9.000 in
Outside Diameter (D)	9.500 in
Width	1/4"
Land Diameter (L ₁)	9.186 in
Land Diameter (L ₂)	9.314 in
Approximate Weight	0.44 lbs
Separator	Brass; snapover separator
Precision Class	ABEC Class 1
Bearing Type	4-Point Contact (Type X)
Seals, Shields	None (Open)
Unit System	Inch

Load Capacities

Static Radial Load	2,810 lbf
Dynamic Radial Load	1,210 lbf
Static Thrust Load	7,020 lbf
Dynamic Thrust Load	2,040 lbf
Static Moment Load	12,990 in-lbs
Dynamic Moment Load	4,205 in-lbs

Interchange

Silverthin	SA090XPO	Kaydon	KA090XPO	Kaydon	KA090XPO	INA	CSXA090
SKF	FPXA900	FAG	L18QA900	NSK	NBX22806	NTN	KXA090
SSB	RA090XPO	RBC	KA090XPO*RBC				

Brass; snapover separator

1/8" balls

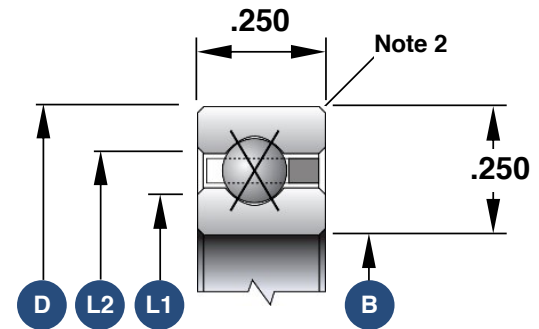

1. Load capacities are not additive
2. The maximum shaft or housing fillet radius that the bearing corners will clear for this series is 0.025"
3. Race Width Tolerance: +0.000 -0.005"

Also Available

Open Angular Contact	SA090ARO
Open Radial Contact	SA090CPO
Open Duplexed (Back-to-Back)	SA090BRO
Open Duplexed (Face-to-Face)	SA090FRO