

SILVERTHIN SA100AR0**10 in Open Type A Thin Section Bearing****Specifications**

Bore (B)	10.000 in
Outside Diameter (D)	10.500 in
Width	1/4"
Land Diameter (L ₁)	10.186 in
Land Diameter (L ₂)	10.314 in
Land Diameter (L ₃)	10.355 in
Approximate Weight	0.50 lbs
Separator	Brass; one piece pocket separator
Precision Class	ABEC Class 1
Bearing Type	Angular Contact (Type A)
Seals, Shields	None (Open)
Unit System	Inch

Load Capacities

Static Radial Load	3,590 lbf
Dynamic Radial Load	1,015 lbf
Static Thrust Load	10,370 lbf
Dynamic Thrust Load	2,640 lbf

Interchange

Silverthin	SA100AR0	Kaydon	KA100AR0
SKF	FPAA1000	FAG	L15QA1000
SSB	RA100AR0	RBC	KA100AR0*RBC

Brass; one piece pocket separator

1/8" balls

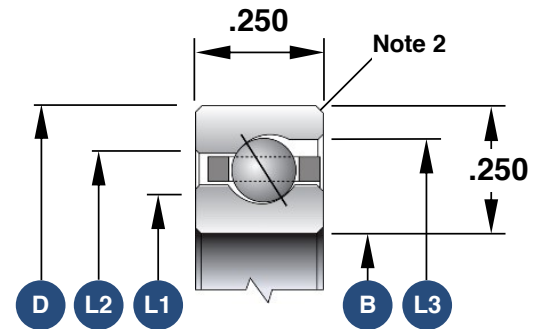

1. Load capacities are not additive
2. The maximum shaft or housing fillet radius that the bearing corners will clear for this series is 0.025"
3. Race Width Tolerance: +0.000 -0.005"

Also Available

Open Radial Contact	SA100CP0
Open 4-Point Contact	SA100XP0
Open Duplexed (Back-to-Back)	SA100BR0
Open Duplexed (Face-to-Face)	SA100FR0