

SILVERTHIN SA100CP0**10 in Open Type C Thin Section Bearing****Specifications**

Bore (B)	10.000 in
Outside Diameter (D)	10.500 in
Width	1/4"
Land Diameter (L ₁)	10.186 in
Land Diameter (L ₂)	10.314 in
Approximate Weight	0.50 lbs
Separator	Brass; snapover separator
Precision Class	ABEC Class 1
Bearing Type	Radial Contact (Type C)
Seals, Shields	None (Open)
Unit System	Inch

Load Capacities

Static Radial Load	3,110 lbf
Dynamic Radial Load	970 lbf

Interchange

Silverthin	SA100CP0	Kaydon	KA100CP0	Kaydon	KA100CP0	INA	CSCA100
SKF	FPCA1000	FAG	L10QA1000	NSK	NBC25406	NTN	KRA100
SSB	RA100CP0	RBC	KA100CP0*RBC				

Brass; snapover separator

1/8" balls

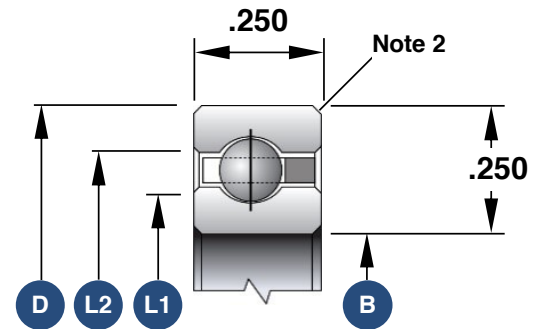

1. Load capacities are not additive
2. The maximum shaft or housing fillet radius that the bearing corners will clear for this series is 0.025"
3. Race Width Tolerance: +0.000 -0.005"

Also Available

Open Angular Contact	SA100ARO
Open 4-Point Contact	SA100XPO
Open Duplexed (Back-to-Back)	SA100BRO
Open Duplexed (Face-to-Face)	SA100FRO