

SILVERTHIN SA100XPO**10 in Open Type X Thin Section Bearing****Specifications**

Bore (B)	10.000 in
Outside Diameter (D)	10.500 in
Width	1/4"
Land Diameter (L ₁)	10.186 in
Land Diameter (L ₂)	10.314 in
Approximate Weight	0.50 lbs
Separator	Brass; snapover separator
Precision Class	ABEC Class 1
Bearing Type	4-Point Contact (Type X)
Seals, Shields	None (Open)
Unit System	Inch

Load Capacities

Static Radial Load	3,110 lbf
Dynamic Radial Load	1,290 lbf
Static Thrust Load	7,780 lbf
Dynamic Thrust Load	2,180 lbf
Static Moment Load	15,940 in-lbs
Dynamic Moment Load	4,955 in-lbs

Interchange

Silverthin	SA100XPO	Kaydon	KA100XPO	Kaydon	KA100XPO	INA	CSXA100
SKF	FPXA1000	FAG	L18QA1000	NSK	NBX25406	NTN	KXA100
SSB	RA100XPO	RBC	KA100XPO*RBC				

Brass; snapover separator

1/8" balls

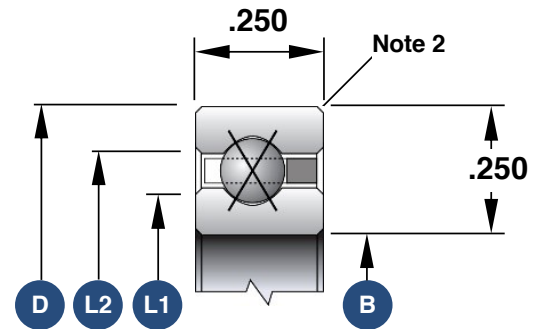

1. Load capacities are not additive
2. The maximum shaft or housing fillet radius that the bearing corners will clear for this series is 0.025"
3. Race Width Tolerance: +0.000 -0.005"

Also Available

Open Angular Contact	SA100ARO
Open Radial Contact	SA100CPO
Open Duplexed (Back-to-Back)	SA100BRO
Open Duplexed (Face-to-Face)	SA100FRO