

SILVERTHIN SA110ARO**11 in Open Type A Thin Section Bearing****Specifications**

Bore (B)	11.000 in
Outside Diameter (D)	11.500 in
Width	1/4"
Land Diameter (L ₁)	11.186 in
Land Diameter (L ₂)	11.314 in
Land Diameter (L ₃)	11.353 in
Approximate Weight	0.52 lbs
Separator	Brass; one piece pocket separator
Precision Class	ABEC Class 1
Bearing Type	Angular Contact (Type A)
Seals, Shields	None (Open)
Unit System	Inch

Load Capacities

Static Radial Load	3,940 lbf
Dynamic Radial Load	1,070 lbf
Static Thrust Load	11,380 lbf
Dynamic Thrust Load	2,810 lbf

Interchange

Silverthin	SA110ARO	Kaydon	KA110ARO
SKF	FPAA1100	FAG	L15QA1100
SSB	RA110ARO	RBC	KA110ARO*RBC

Brass; one piece pocket separator

1/8" balls

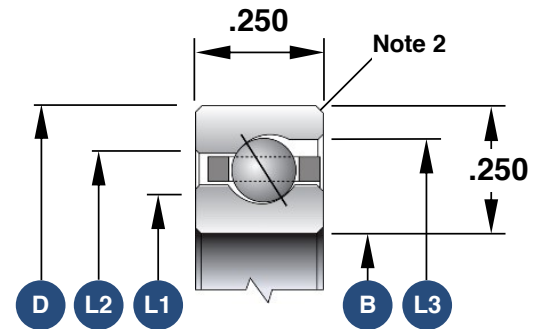

1. Load capacities are not additive
2. The maximum shaft or housing fillet radius that the bearing corners will clear for this series is 0.025"
3. Race Width Tolerance: +0.000 -0.005"

Also Available

Open Radial Contact	SA110CP0
Open 4-Point Contact	SA110XP0
Open Duplexed (Back-to-Back)	SA110BR0
Open Duplexed (Face-to-Face)	SA110FR0