

SILVERTHIN SA110CP0**11 in Open Type C Thin Section Bearing****Specifications**

Bore (B)	11.000 in
Outside Diameter (D)	11.500 in
Width	1/4"
Land Diameter (L ₁)	11.186 in
Land Diameter (L ₂)	11.314 in
Approximate Weight	0.52 lbs
Separator	Brass; snapover separator
Precision Class	ABEC Class 1
Bearing Type	Radial Contact (Type C)
Seals, Shields	None (Open)
Unit System	Inch

Load Capacities

Static Radial Load	3,410 lbf
Dynamic Radial Load	1,025 lbf

Interchange

Silverthin	SA110CP0	Kaydon	KA110CP0	Kaydon	KA110CP0	INA	CSCA110
SKF	FPCA1100	FAG	L10QA1100	NSK	NBC27906	NTN	KRA110
SSB	RA110CP0	RBC	KA110CP0*RBC				

Brass; snapover separator

1/8" balls

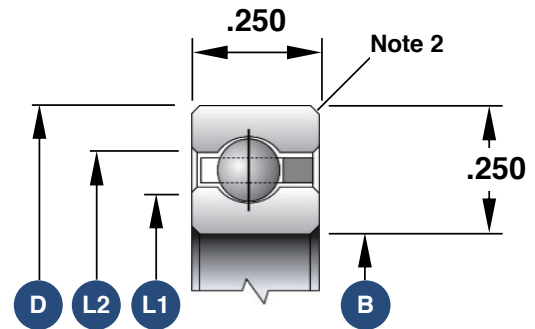

1. Load capacities are not additive
2. The maximum shaft or housing fillet radius that the bearing corners will clear for this series is 0.025"
3. Race Width Tolerance: +0.000 -0.005"

Also Available

Open Angular Contact	SA110ARO
Open 4-Point Contact	SA110XPO
Open Duplexed (Back-to-Back)	SA110BR0
Open Duplexed (Face-to-Face)	SA110FR0