

SILVERTHIN SA110XPO**11 in Open Type X Thin Section Bearing****Specifications**

Bore (B)	11.000 in
Outside Diameter (D)	11.500 in
Width	1/4"
Land Diameter (L ₁)	11.186 in
Land Diameter (L ₂)	11.314 in
Approximate Weight	0.52 lbs
Separator	Brass; snapover separator
Precision Class	ABEC Class 1
Bearing Type	4-Point Contact (Type X)
Seals, Shields	None (Open)
Unit System	Inch

Load Capacities

Static Radial Load	3,410 lbf
Dynamic Radial Load	1,360 lbf
Static Thrust Load	8,540 lbf
Dynamic Thrust Load	2,320 lbf
Static Moment Load	19,210 in-lbs
Dynamic Moment Load	5,750 in-lbs

Interchange

Silverthin	SA110XPO	Kaydon	KA110XPO	Kaydon	KA110XPO	INA	CSXA110
SKF	FPXA1100	FAG	L18QA1100	NSK	NBX27606	NTN	KXA110
SSB	RA110XPO	RBC	KA110XPO*RBC				

Brass; snapover separator

1/8" balls

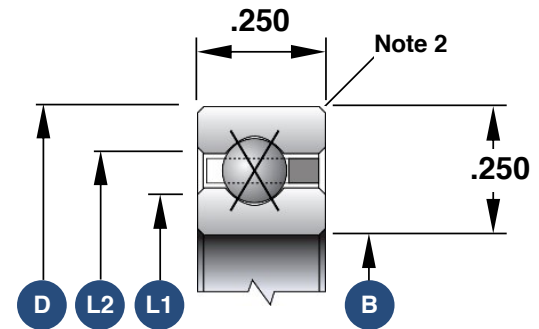

1. Load capacities are not additive
2. The maximum shaft or housing fillet radius that the bearing corners will clear for this series is 0.025"
3. Race Width Tolerance: +0.000 -0.005"

Also Available

Open Angular Contact	SA110ARO
Open Radial Contact	SA110CPO
Open Duplexed (Back-to-Back)	SA110BR0
Open Duplexed (Face-to-Face)	SA110FR0