

SILVERTHIN SA120AR0**12 in Open Type A Thin Section Bearing****Specifications**

Bore (B)	12.000 in
Outside Diameter (D)	12.500 in
Width	1/4"
Land Diameter (L ₁)	12.186 in
Land Diameter (L ₂)	12.314 in
Land Diameter (L ₃)	12.349 in
Approximate Weight	0.56 lbs
Separator	Brass; one piece pocket separator
Precision Class	ABEC Class 1
Bearing Type	Angular Contact (Type A)
Seals, Shields	None (Open)
Unit System	Inch

Load Capacities

Static Radial Load	4,290 lbf
Dynamic Radial Load	1,130 lbf
Static Thrust Load	12,390 lbf
Dynamic Thrust Load	2,970 lbf

Interchange

Silverthin	SA120AR0	Kaydon	KA120AR0
SKF	FPA1200	FAG	L15QA1200
SSB	RA120AR0	RBC	KA120AR0*RBC

Brass; one piece pocket separator

1/8" balls

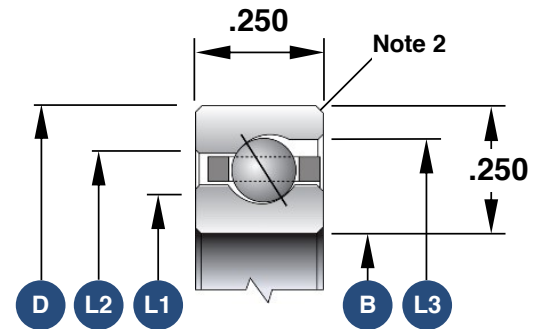

1. Load capacities are not additive
2. The maximum shaft or housing fillet radius that the bearing corners will clear for this series is 0.025"
3. Race Width Tolerance: +0.000 -0.005"

Also Available

Open Radial Contact	SA120CP0
Open 4-Point Contact	SA120XP0
Open Duplexed (Back-to-Back)	SA120BR0
Open Duplexed (Face-to-Face)	SA120FR0