

**SILVERTHIN SA120CP0****12 in Open Type C Thin Section Bearing****Specifications**

Bore (B)	12.000 in
Outside Diameter (D)	12.500 in
Width	1/4"
Land Diameter (L <sub>1</sub> )	12.186 in
Land Diameter (L <sub>2</sub> )	12.314 in
Approximate Weight	0.56 lbs
Separator	Brass; snapover separator
Precision Class	ABEC Class 1
Bearing Type	Radial Contact (Type C)
Seals, Shields	None (Open)
Unit System	Inch

**Load Capacities**

Static Radial Load	3,720 lbf
Dynamic Radial Load	1,080 lbf

**Interchange**

Silverthin	SA120CP0	Kaydon	KA120CP0	Kaydon	KA120CP0	INA	CSCA120
SKF	FPCA1200	FAG	L10QA1200	NSK	NBC30406	NTN	KRA120
SSB	RA120CP0	RBC	KA120CP0*RBC				

**Brass; snapover separator**

1/8" balls

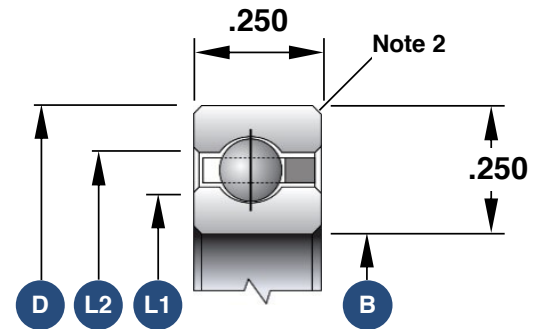

1. Load capacities are not additive
2. The maximum shaft or housing fillet radius that the bearing corners will clear for this series is 0.025"
3. Race Width Tolerance: +0.000 -0.005"

**Also Available**

Open Angular Contact	SA120ARO
Open 4-Point Contact	SA120XPO
Open Duplexed (Back-to-Back)	SA120BRO
Open Duplexed (Face-to-Face)	SA120FRO