

**SILVERTHIN SA120XP0****12 in Open Type X Thin Section Bearing****Specifications**

Bore (B)	12.000 in
Outside Diameter (D)	12.500 in
Width	1/4"
Land Diameter (L <sub>1</sub> )	12.186 in
Land Diameter (L <sub>2</sub> )	12.314 in
Approximate Weight	0.56 lbs
Separator	Brass; snapover separator
Precision Class	ABEC Class 1
Bearing Type	4-Point Contact (Type X)
Seals, Shields	None (Open)
Unit System	Inch

**Load Capacities**

Static Radial Load	3,720 lbf
Dynamic Radial Load	1,435 lbf
Static Thrust Load	9,300 lbf
Dynamic Thrust Load	2,450 lbf
Static Moment Load	22,770 in-lbs
Dynamic Moment Load	6,585 in-lbs

**Interchange**

Silverthin	SA120XP0	Kaydon	KA120XP0	Kaydon	KA120XP0	INA	CSXA120
SKF	FPXA1200	FAG	L18QA1200	NSK	NBX30406	NTN	KXA120
SSB	RA120XP0	RBC	KA120XP0*RBC				

**Brass; snapover separator**

1/8" balls

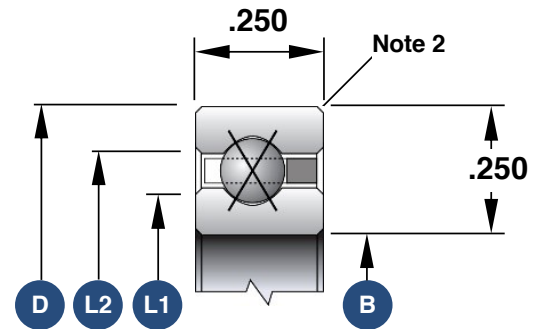

1. Load capacities are not additive
2. The maximum shaft or housing fillet radius that the bearing corners will clear for this series is 0.025"
3. Race Width Tolerance: +0.000 -0.005"

**Also Available**

Open Angular Contact	SA120AR0
Open Radial Contact	SA120CP0
Open Duplexed (Back-to-Back)	SA120BR0
Open Duplexed (Face-to-Face)	SA120FR0