

SILVERTHIN SAA10AGO**1 in Open Type A Thin Section Bearing****Specifications**

Bore (B)	1.000 in
Outside Diameter (D)	1.375 in
Width	3/16"
Land Diameter (L ₁)	1.140 in
Land Diameter (L ₂)	1.235 in
Land Diameter (L ₃)	1.274 in
Approximate Weight	0.03 lbs
Separator	Nylon; circular pocket separator
Precision Class	ABEC Class 1
Bearing Type	Angular Contact (Type A)
Seals, Shields	None (Open)
Unit System	Inch

Load Capacities

Static Radial Load	340 lbf
Dynamic Radial Load	195 lbf
Static Thrust Load	970 lbf
Dynamic Thrust Load	450 lbf

Interchange

Silverthin	SAA10AGO	Kaydon	KAA10AGO
SKF	FPAB100	FAG	L15PA100
SSB	RAA10AGO	RBC	KAA10AGO*RBC

Nylon; circular pocket separator

3/32" balls

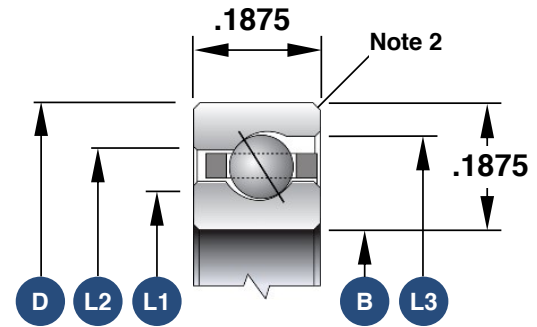

1. Load capacities are not additive
2. The maximum shaft or housing fillet radius that the bearing corners will clear for this series is 0.015"
3. Race Width Tolerance: +0.000 -0.005"

Also Available

Open Radial Contact	SAA10CLO
Open 4-Point Contact	SAA10XLO
Sealed Radial Contact ¹	JSHA10CLO
Sealed 4-Point Contact ¹	JSHA10XLO
Open Duplexed (Back-to-Back)	SAA10BGO
Open Duplexed (Face-to-Face)	SAA10FGO

1. Larger width than SAA to accommodate a seal