

Specifications

Bore (B)	1.000 in
Outside Diameter (D)	1.375 in
Width	3/16"
Land Diameter (L ₁)	1.140 in
Land Diameter (L ₂)	1.235 in
Approximate Weight	0.03 lbs
Separator	Nylon; one piece snapover separator
Precision Class	ABEC Class 1
Bearing Type	Radial Contact (Type C)
Seals, Shields	None (Open)
Unit System	Inch

Load Capacities

Static Radial Load	290 lbf
Dynamic Radial Load	190 lbf

Interchange

Silverthin	SAA10CLO	Kaydon	KAA10CLO
SKF	FPCB100	FAG	L10PA100
SSB	RAA10CLO	RBC	KAA10CLO*RBC

Nylon; one piece snapover separator

3/32" balls

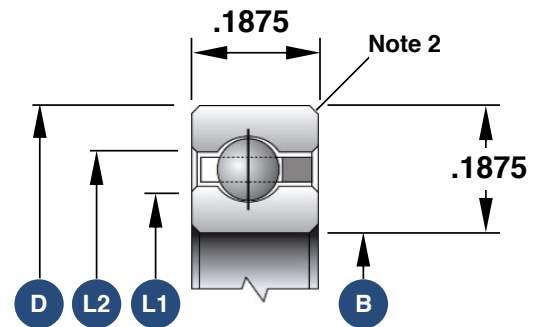

1. Load capacities are not additive
2. The maximum shaft or housing fillet radius that the bearing corners will clear for this series is 0.015"
3. Race Width Tolerance: +0.000 -0.005"

Also Available

Open Angular Contact	SAA10AGO
Open 4-Point Contact	SAA10XL0
Sealed Radial Contact ¹	JSHA10CLO
Sealed 4-Point Contact ¹	JSHA10XL0
Open Duplexed (Back-to-Back)	SAA10BG0
Open Duplexed (Face-to-Face)	SAA10FG0

1. Larger width than SAA to accommodate a seal