

SILVERTHIN SAA15AG0**1.5 in Open Type A Thin Section Bearing****Specifications**

Bore (B)	1.500 in
Outside Diameter (D)	1.875 in
Width	3/16"
Land Diameter (L ₁)	1.640 in
Land Diameter (L ₂)	1.735 in
Land Diameter (L ₃)	1.774 in
Approximate Weight	0.04 lbs
Separator	Nylon; circular pocket separator
Precision Class	ABEC Class 1
Bearing Type	Angular Contact (Type A)
Seals, Shields	None (Open)
Unit System	Inch

Load Capacities

Static Radial Load	480 lbf
Dynamic Radial Load	240 lbf
Static Thrust Load	1,380 lbf
Dynamic Thrust Load	560 lbf

Interchange

Silverthin	SAA15AG0	Kaydon	KAA15AG0
SKF	FPAB108	FAG	L15PA108
SSB	RAA15AG0	RBC	KAA15AG0*RBC

Nylon; circular pocket separator

3/32" balls

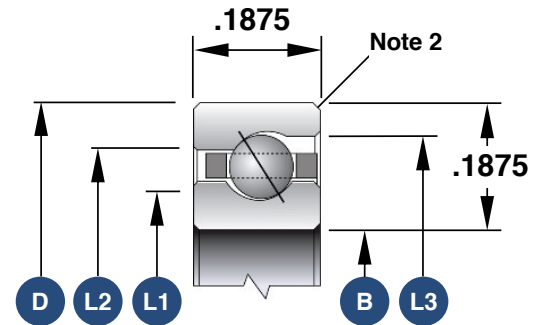

1. Load capacities are not additive
2. The maximum shaft or housing fillet radius that the bearing corners will clear for this series is 0.015"
3. Race Width Tolerance: +0.000 -0.005"

Also Available

Open Radial Contact	SAA15CLO
Open 4-Point Contact	SAA15XL0
Sealed Radial Contact ¹	JSHA15CLO
Sealed 4-Point Contact ¹	JSHA15XL0
Open Duplexed (Back-to-Back)	SAA15BG0
Open Duplexed (Face-to-Face)	SAA15FG0

1. Larger width than SAA to accommodate a seal