

SILVERTHIN SAA15CLO**1.5 in Open Type C Thin Section Bearing****Specifications**

Bore (B)	1.500 in
Outside Diameter (D)	1.875 in
Width	3/16"
Land Diameter (L ₁)	1.640 in
Land Diameter (L ₂)	1.735 in
Approximate Weight	0.04 lbs
Separator	Nylon; one piece snapover separator
Precision Class	ABEC Class 1
Bearing Type	Radial Contact (Type C)
Seals, Shields	None (Open)
Unit System	Inch

Load Capacities

Static Radial Load	400 lbf
Dynamic Radial Load	225 lbf

Interchange

Silverthin	SAA15CLO	Kaydon	KAA15CLO	Kaydon	KAA15CLO	INA	CSCAA015
SKF	FPCB108	FAG	L10PA108	NSK	NBC3804	NTN	KRS015
SSB	RAA15CLO	RBC	KAA15CLO*RBC				

Nylon; one piece snapover separator

3/32" balls

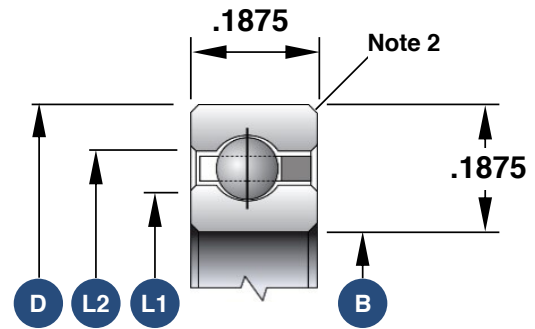

1. Load capacities are not additive
2. The maximum shaft or housing fillet radius that the bearing corners will clear for this series is 0.015"
3. Race Width Tolerance: +0.000 -0.005"

Also Available

Open Angular Contact	SAA15AG0
Open 4-Point Contact	SAA15XL0
Sealed Radial Contact ¹	JSHA15CLO
Sealed 4-Point Contact ¹	JSHA15XL0
Open Duplexed (Back-to-Back)	SAA15BG0
Open Duplexed (Face-to-Face)	SAA15FG0

1. Larger width than SAA to accommodate a seal