

SILVERTHIN SAA17AG0**1.75 in Open Type A Thin Section Bearing****Specifications**

Bore (B)	1.750 in
Outside Diameter (D)	2.125 in
Width	3/16"
Land Diameter (L ₁)	1.890 in
Land Diameter (L ₂)	1.985 in
Land Diameter (L ₃)	1.990 in
Approximate Weight	0.04 lbs
Separator	Nylon; circular pocket separator
Precision Class	ABEC Class 1
Bearing Type	Angular Contact (Type A)
Seals, Shields	None (Open)
Unit System	Inch

Load Capacities

Static Radial Load	530 lbf
Dynamic Radial Load	250 lbf
Static Thrust Load	1,520 lbf
Dynamic Thrust Load	600 lbf

Interchange

Silverthin	SAA17AG0	Kaydon	KAA17AG0
SKF	FPAB112	FAG	L15PA112
SSB	RAA17AG0	RBC	KAA17AG0*RBC

Nylon; circular pocket separator

3/32" balls

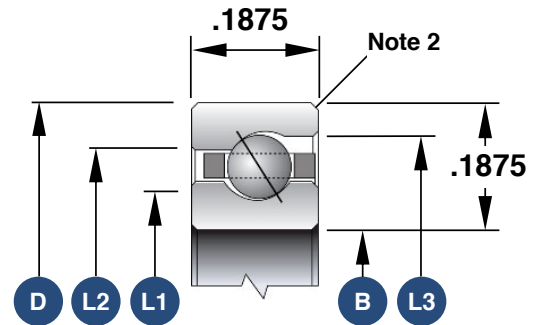

1. Load capacities are not additive
2. The maximum shaft or housing fillet radius that the bearing corners will clear for this series is 0.015"
3. Race Width Tolerance: +0.000 -0.005"

Also Available

Open Radial Contact	SAA17CLO
Open 4-Point Contact	SAA17XL0
Sealed Radial Contact ¹	JSHA17CLO
Sealed 4-Point Contact ¹	JSHA17XL0
Open Duplexed (Back-to-Back)	SAA17BG0
Open Duplexed (Face-to-Face)	SAA17FG0

1. Larger width than SAA to accommodate a seal