

SILVERTHIN SB020AR0**2 in Open Type A Thin Section Bearing****Specifications**

Bore (B)	2.000 in
Outside Diameter (D)	2.625 in
Width	5/16"
Land Diameter (L ₁)	2.231 in
Land Diameter (L ₂)	2.393 in
Land Diameter (L ₃)	2.464 in
Approximate Weight	0.16 lbs
Separator	Brass; one piece pocket separator
Precision Class	ABEC Class 1
Bearing Type	Angular Contact (Type A)
Seals, Shields	None (Open)
Unit System	Inch

Load Capacities

Static Radial Load	1,090 lbf
Dynamic Radial Load	600 lbf
Static Thrust Load	3,150 lbf
Dynamic Thrust Load	1,380 lbf

Interchange

Silverthin	SB020AR0	Kaydon	KB020AR0	Kaydon	KB020AR0	INA	CSEB020
SKF	FPAB200	FAG	L15RA200	NSK	NBA5007	NTN	KYB020
SSB	RB020AR0	RBC	KB020AR0*RBC				

Brass; one piece pocket separator

5/32" balls

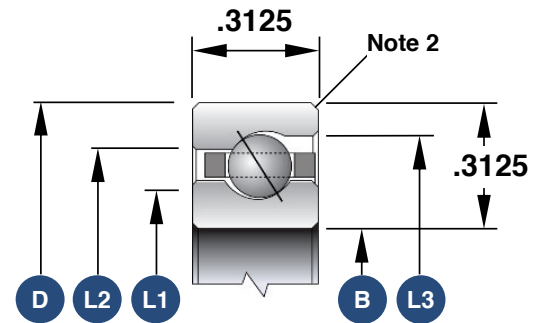

1. Load capacities are not additive
2. The maximum shaft or housing fillet radius that the bearing corners will clear for this series is 0.040"
3. Race Width Tolerance: +0.000 -0.005"

Also Available

Open Radial Contact	SB020CP0
Open 4-Point Contact	SB020XP0
Sealed Radial Contact	JSB020CP0
Sealed 4-Point Contact	JSB020XP0
Open Duplexed (Back-to-Back)	SB020BR0
Open Duplexed (Face-to-Face)	SB020FR0