

SILVERTHIN SB020CP0**2 in Open Type C Thin Section Bearing****Specifications**

Bore (B)	2.000 in
Outside Diameter (D)	2.625 in
Width	5/16"
Land Diameter (L ₁)	2.231 in
Land Diameter (L ₂)	2.393 in
Approximate Weight	0.16 lbs
Separator	Brass; snapover separator
Precision Class	ABEC Class 1
Bearing Type	Radial Contact (Type C)
Seals, Shields	None (Open)
Unit System	Inch

Load Capacities

Static Radial Load	930 lbf
Dynamic Radial Load	575 lbf

Interchange

Silverthin	SB020CP0	Kaydon	KB020CP0	Kaydon	KB020CP0	INA	CSCB020
SKF	FPCB200	FAG	L10RA200	NSK	NBC5007	NTN	KRB020
SSB	RB020CP0	RBC	KB020CP0*RBC				

Brass; snapover separator

5/32" balls

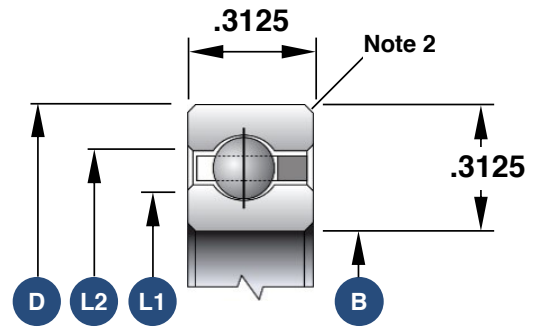

1. Load capacities are not additive
2. The maximum shaft or housing fillet radius that the bearing corners will clear for this series is 0.040"
3. Race Width Tolerance: +0.000 -0.005"

Also Available

Open Angular Contact	SB020AR0
Open 4-Point Contact	SB020XP0
Sealed Radial Contact	JSB020CP0
Sealed 4-Point Contact	JSB020XP0
Open Duplexed (Back-to-Back)	SB020BR0
Open Duplexed (Face-to-Face)	SB020FR0