

SILVERTHIN SB020XP0**2 in Open Type X Thin Section Bearing****Specifications**

Bore (B)	2.000 in
Outside Diameter (D)	2.625 in
Width	5/16"
Land Diameter (L ₁)	2.231 in
Land Diameter (L ₂)	2.393 in
Approximate Weight	0.16 lbs
Separator	Brass; snapover separator
Precision Class	ABEC Class 1
Bearing Type	4-Point Contact (Type X)
Seals, Shields	None (Open)
Unit System	Inch

Load Capacities

Static Radial Load	930 lbf
Dynamic Radial Load	760 lbf
Static Thrust Load	2,340 lbf
Dynamic Thrust Load	1,130 lbf
Static Moment Load	1,080 in-lbs
Dynamic Moment Load	660 in-lbs

Interchange

Silverthin	SB020XP0	Kaydon	KB020XP0	Kaydon	KB020XP0	INA	CSXB020
SKF	FPXB200	FAG	L18RA200	NSK	NBX5007	NTN	KXB020
SSB	RB020XP0	RBC	KB020XP0*RBC				

Brass; snapover separator

5/32" balls

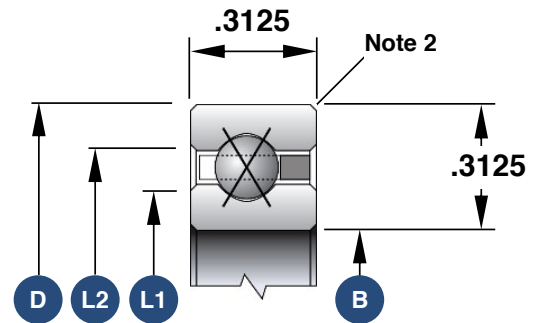

1. Load capacities are not additive
2. The maximum shaft or housing fillet radius that the bearing corners will clear for this series is 0.040"
3. Race Width Tolerance: +0.000 -0.005"

Also Available

Open Angular Contact	SB020AR0
Open Radial Contact	SB020CP0
Sealed Radial Contact	JSB020CP0
Sealed 4-Point Contact	JSB020XP0
Open Duplexed (Back-to-Back)	SB020BR0
Open Duplexed (Face-to-Face)	SB020FR0