

SILVERTHIN SB025AR0**2.5 in Open Type A Thin Section Bearing****Specifications**

Bore (B)	2.500 in
Outside Diameter (D)	3.125 in
Width	5/16"
Land Diameter (L ₁)	2.731 in
Land Diameter (L ₂)	2.893 in
Land Diameter (L ₃)	2.964 in
Approximate Weight	0.19 lbs
Separator	Brass; one piece pocket separator
Precision Class	ABEC Class 1
Bearing Type	Angular Contact (Type A)
Seals, Shields	None (Open)
Unit System	Inch

Load Capacities

Static Radial Load	1,340 lbf
Dynamic Radial Load	675 lbf
Static Thrust Load	3,860 lbf
Dynamic Thrust Load	1,590 lbf

Interchange

Silverthin	SB025AR0	Kaydon	KB025AR0	Kaydon	KB025AR0	INA	CSEB025
SKF	FPAB208	FAG	L15RA208	NSK	NBA6307	NTN	KYB025
SSB	RB025AR0	RBC	KB025AR0*RBC				

Brass; one piece pocket separator

5/32" balls

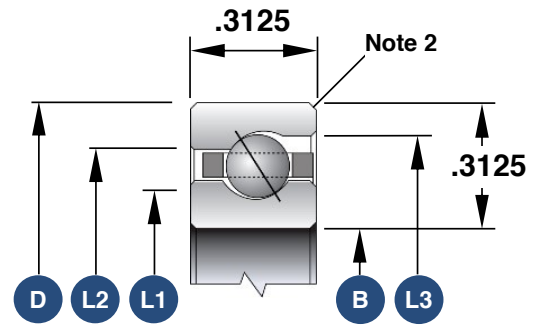

1. Load capacities are not additive
2. The maximum shaft or housing fillet radius that the bearing corners will clear for this series is 0.040"
3. Race Width Tolerance: +0.000 -0.005"

Also Available

Open Radial Contact	SB025CP0
Open 4-Point Contact	SB025XP0
Sealed Radial Contact	JSB025CP0
Sealed 4-Point Contact	JSB025XP0
Open Duplexed (Back-to-Back)	SB025BR0
Open Duplexed (Face-to-Face)	SB025FR0