

SILVERTHIN SB025CP0**2.5 in Open Type C Thin Section Bearing****Specifications**

Bore (B)	2.500 in
Outside Diameter (D)	3.125 in
Width	5/16"
Land Diameter (L ₁)	2.731 in
Land Diameter (L ₂)	2.893 in
Approximate Weight	0.19 lbs
Separator	Brass; snapover separator
Precision Class	ABEC Class 1
Bearing Type	Radial Contact (Type C)
Seals, Shields	None (Open)
Unit System	Inch

Load Capacities

Static Radial Load	1,140 lbf
Dynamic Radial Load	645 lbf

Interchange

Silverthin	SB025CP0	Kaydon	KB025CP0	Kaydon	KB025CP0	INA	CSCB025
SKF	FPCB208	FAG	L10RA208	NSK	NBC6307	NTN	KRB025
SSB	RB025CP0	RBC	KB025CP0*RBC				

Brass; snapover separator

5/32" balls

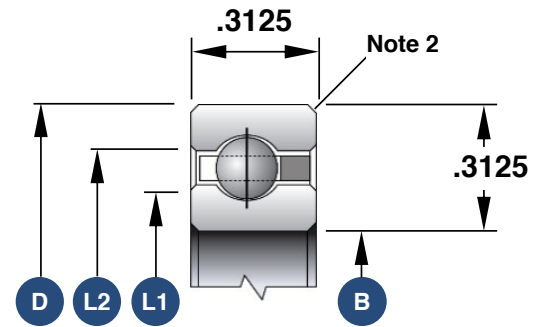

1. Load capacities are not additive
2. The maximum shaft or housing fillet radius that the bearing corners will clear for this series is 0.040"
3. Race Width Tolerance: +0.000 -0.005"

Also Available

Open Angular Contact	SB025AR0
Open 4-Point Contact	SB025XP0
Sealed Radial Contact	JSB025CP0
Sealed 4-Point Contact	JSB025XP0
Open Duplexed (Back-to-Back)	SB025BR0
Open Duplexed (Face-to-Face)	SB025FR0