

SILVERTHIN SB025XP0**2.5 in Open Type X Thin Section Bearing****Specifications**

Bore (B)	2.500 in
Outside Diameter (D)	3.125 in
Width	5/16"
Land Diameter (L ₁)	2.731 in
Land Diameter (L ₂)	2.893 in
Approximate Weight	0.19 lbs
Separator	Brass; snapover separator
Precision Class	ABEC Class 1
Bearing Type	4-Point Contact (Type X)
Seals, Shields	None (Open)
Unit System	Inch

Load Capacities

Static Radial Load	1,140 lbf
Dynamic Radial Load	850 lbf
Static Thrust Load	2,840 lbf
Dynamic Thrust Load	1,290 lbf
Static Moment Load	1,600 in-lbs
Dynamic Moment Load	895 in-lbs

Interchange

Silverthin	SB025XP0	Kaydon	KB025XP0	Kaydon	KB025XP0	INA	CSXB025
SKF	FPXB208	FAG	L18RA208	NSK	NBX6307	NTN	KXB025
SSB	RB025XP0	RBC	KB025XP0*RBC				

Brass; snapover separator

5/32" balls

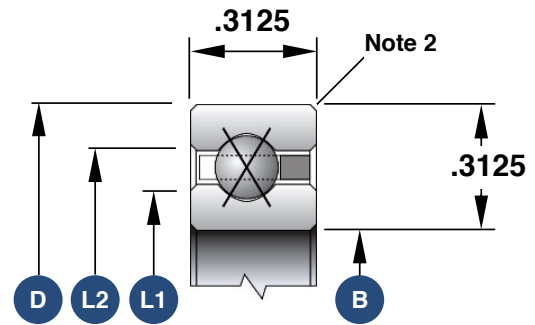

1. Load capacities are not additive
2. The maximum shaft or housing fillet radius that the bearing corners will clear for this series is 0.040"
3. Race Width Tolerance: +0.000 -0.005"

Also Available

Open Angular Contact	SB025AR0
Open Radial Contact	SB025CP0
Sealed Radial Contact	JSB025CP0
Sealed 4-Point Contact	JSB025XP0
Open Duplexed (Back-to-Back)	SB025BR0
Open Duplexed (Face-to-Face)	SB025FR0