

SILVERTHIN SB030AR0**3 in Open Type A Thin Section Bearing****Specifications**

Bore (B)	3.000 in
Outside Diameter (D)	3.625 in
Width	5/16"
Land Diameter (L ₁)	3.231 in
Land Diameter (L ₂)	3.393 in
Land Diameter (L ₃)	3.462 in
Approximate Weight	0.24 lbs
Separator	Brass; one piece pocket separator
Precision Class	ABEC Class 1
Bearing Type	Angular Contact (Type A)
Seals, Shields	None (Open)
Unit System	Inch

Load Capacities

Static Radial Load	1,550 lbf
Dynamic Radial Load	735 lbf
Static Thrust Load	4,470 lbf
Dynamic Thrust Load	1,750 lbf

Interchange

Silverthin	SB030AR0	Kaydon	KB030AR0	Kaydon	KB030AR0	INA	CSEB030
SKF	FPAB300	FAG	L15RA300	NSK	NBA7607	NTN	KYB030
SSB	RB030AR0	RBC	KB030AR0*RBC				

Brass; one piece pocket separator

5/32" balls

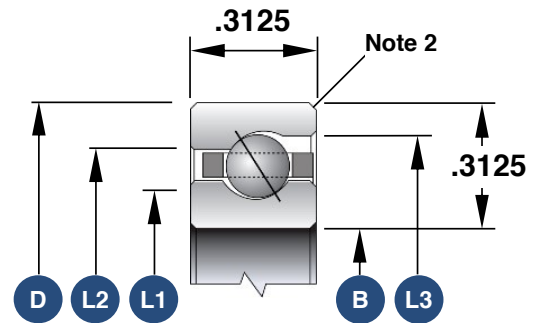

1. Load capacities are not additive
2. The maximum shaft or housing fillet radius that the bearing corners will clear for this series is 0.040"
3. Race Width Tolerance: +0.000 -0.005"

Also Available

Open Radial Contact	SB030CP0
Open 4-Point Contact	SB030XP0
Sealed Radial Contact	JSB030CP0
Sealed 4-Point Contact	JSB030XP0
Open Duplexed (Back-to-Back)	SB030BR0
Open Duplexed (Face-to-Face)	SB030FR0