

SILVERTHIN SB030CP0**3 in Open Type C Thin Section Bearing****Specifications**

Bore (B)	3.000 in
Outside Diameter (D)	3.625 in
Width	5/16"
Land Diameter (L ₁)	3.231 in
Land Diameter (L ₂)	3.393 in
Approximate Weight	0.24 lbs
Separator	Brass; snapover separator
Precision Class	ABEC Class 1
Bearing Type	Radial Contact (Type C)
Seals, Shields	None (Open)
Unit System	Inch

Load Capacities

Static Radial Load	1,340 lbf
Dynamic Radial Load	705 lbf

Interchange

Silverthin	SB030CP0	Kaydon	KB030CP0	Kaydon	KB030CP0	INA	CSCB030
SKF	FPCB300	FAG	L10RA300	NSK	NBC7607	NTN	KRB030
SSB	RB030CP0	RBC	KB030CP0*RBC				

Brass; snapover separator

5/32" balls

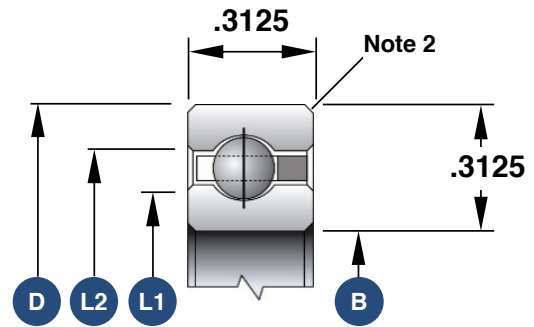

1. Load capacities are not additive
2. The maximum shaft or housing fillet radius that the bearing corners will clear for this series is 0.040"
3. Race Width Tolerance: +0.000 -0.005"

Also Available

Open Angular Contact	SB030AR0
Open 4-Point Contact	SB030XP0
Sealed Radial Contact	JSB030CP0
Sealed 4-Point Contact	JSB030XP0
Open Duplexed (Back-to-Back)	SB030BR0
Open Duplexed (Face-to-Face)	SB030FR0