

**SILVERTHIN SB030XP0****3 in Open Type X Thin Section Bearing****Specifications**

Bore (B)	3.000 in
Outside Diameter (D)	3.625 in
Width	5/16"
Land Diameter (L <sub>1</sub> )	3.231 in
Land Diameter (L <sub>2</sub> )	3.393 in
Approximate Weight	0.24 lbs
Separator	Brass; snapover separator
Precision Class	ABEC Class 1
Bearing Type	4-Point Contact (Type X)
Seals, Shields	None (Open)
Unit System	Inch

**Load Capacities**

Static Radial Load	1,340 lbf
Dynamic Radial Load	935 lbf
Static Thrust Load	3,350 lbf
Dynamic Thrust Load	1,440 lbf
Static Moment Load	2,220 in-lbs
Dynamic Moment Load	1,160 in-lbs

**Interchange**

Silverthin	<b>SB030XP0</b>	Kaydon	<b>KB030XP0</b>	Kaydon	<b>KB030XP0</b>	INA	<b>CSXB030</b>
SKF	<b>FPXB300</b>	FAG	<b>L18RA300</b>	NSK	<b>NBX7607</b>	NTN	<b>KXB030</b>
SSB	<b>RB030XP0</b>	RBC	<b>KB030XP0*RBC</b>				

**Brass; snapover separator**

5/32" balls

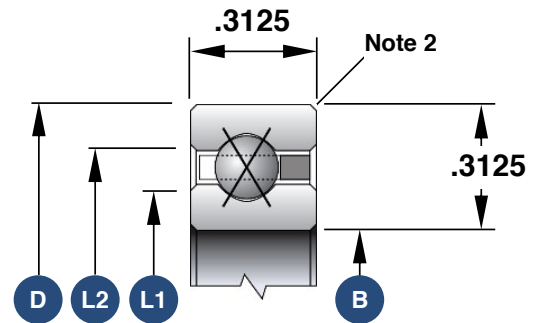

1. Load capacities are not additive
2. The maximum shaft or housing fillet radius that the bearing corners will clear for this series is 0.040"
3. Race Width Tolerance: +0.000 -0.005"

**Also Available**

Open Angular Contact	<b>SB030AR0</b>
Open Radial Contact	<b>SB030CP0</b>
Sealed Radial Contact	<b>JSB030CP0</b>
Sealed 4-Point Contact	<b>JSB030XP0</b>
Open Duplexed (Back-to-Back)	<b>SB030BR0</b>
Open Duplexed (Face-to-Face)	<b>SB030FR0</b>