

SILVERTHIN SB035AR0**3.5 in Open Type A Thin Section Bearing****Specifications**

Bore (B)	3.500 in
Outside Diameter (D)	4.125 in
Width	5/16"
Land Diameter (L ₁)	3.731 in
Land Diameter (L ₂)	3.893 in
Land Diameter (L ₃)	3.962 in
Approximate Weight	0.29 lbs
Separator	Brass; one piece pocket separator
Precision Class	ABEC Class 1
Bearing Type	Angular Contact (Type A)
Seals, Shields	None (Open)
Unit System	Inch

Load Capacities

Static Radial Load	1,790 lbf
Dynamic Radial Load	800 lbf
Static Thrust Load	5,180 lbf
Dynamic Thrust Load	1,930 lbf

Interchange

Silverthin	SB035AR0	Kaydon	KB035AR0	Kaydon	KB035AR0	INA	CSEB035
SKF	FPAB308	FAG	L15RA308	NSK	NBA8807	NTN	KYB035
SSB	RB035AR0	RBC	KB035AR0*RBC				

Brass; one piece pocket separator

5/32" balls

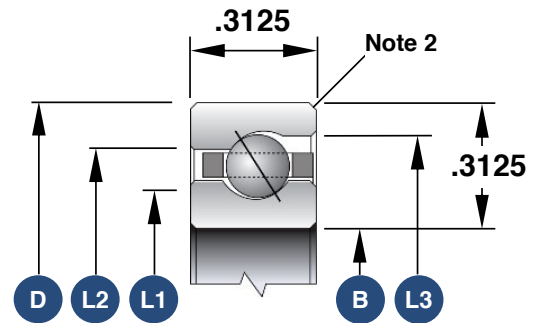

1. Load capacities are not additive
2. The maximum shaft or housing fillet radius that the bearing corners will clear for this series is 0.040"
3. Race Width Tolerance: +0.000 -0.005"

Also Available

Open Radial Contact	SB035CP0
Open 4-Point Contact	SB035XP0
Sealed Radial Contact	JSB035CP0
Sealed 4-Point Contact	JSB035XP0
Open Duplexed (Back-to-Back)	SB035BR0
Open Duplexed (Face-to-Face)	SB035FR0