

SILVERTHIN SB035CP0**3.5 in Open Type C Thin Section Bearing****Specifications**

Bore (B)	3.500 in
Outside Diameter (D)	4.125 in
Width	5/16"
Land Diameter (L ₁)	3.731 in
Land Diameter (L ₂)	3.893 in
Approximate Weight	0.29 lbs
Separator	Brass; snapover separator
Precision Class	ABEC Class 1
Bearing Type	Radial Contact (Type C)
Seals, Shields	None (Open)
Unit System	Inch

Load Capacities

Static Radial Load	1,540 lbf
Dynamic Radial Load	765 lbf

Interchange

Silverthin	SB035CP0	Kaydon	KB035CP0	Kaydon	KB035CP0	INA	CSCB035
SKF	FPCB308	FAG	L10RA308	NSK	NBC8807	NTN	KRB035
SSB	RB035CP0	RBC	KB035CP0*RBC				

Brass; snapover separator

5/32" balls

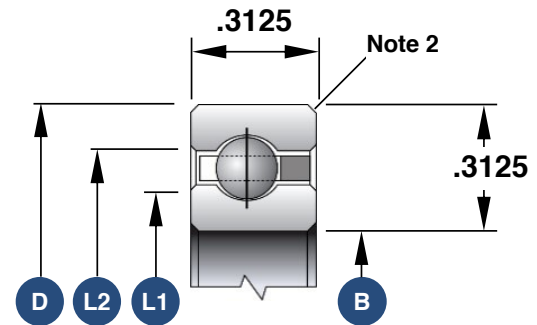

1. Load capacities are not additive
2. The maximum shaft or housing fillet radius that the bearing corners will clear for this series is 0.040"
3. Race Width Tolerance: +0.000 -0.005"

Also Available

Open Angular Contact	SB035AR0
Open 4-Point Contact	SB035XP0
Sealed Radial Contact	JSB035CP0
Sealed 4-Point Contact	JSB035XP0
Open Duplexed (Back-to-Back)	SB035BR0
Open Duplexed (Face-to-Face)	SB035FR0