

SILVERTHIN SB035XP0**3.5 in Open Type X Thin Section Bearing****Specifications**

Bore (B)	3.500 in
Outside Diameter (D)	4.125 in
Width	5/16"
Land Diameter (L ₁)	3.731 in
Land Diameter (L ₂)	3.893 in
Approximate Weight	0.29 lbs
Separator	Brass; snapover separator
Precision Class	ABEC Class 1
Bearing Type	4-Point Contact (Type X)
Seals, Shields	None (Open)
Unit System	Inch

Load Capacities

Static Radial Load	1,540 lbf
Dynamic Radial Load	1,015 lbf
Static Thrust Load	3,860 lbf
Dynamic Thrust Load	1,590 lbf
Static Moment Load	2,940 in-lbs
Dynamic Moment Load	1,450 in-lbs

Interchange

Silverthin	SB035XP0	Kaydon	KB035XP0	Kaydon	KB035XP0	INA	CSXB035
SKF	FPXB308	FAG	L18RA308	NSK	NBX8807	NTN	KXB035
SSB	RB035XP0	RBC	KB035XP0*RBC				

Brass; snapover separator

5/32" balls

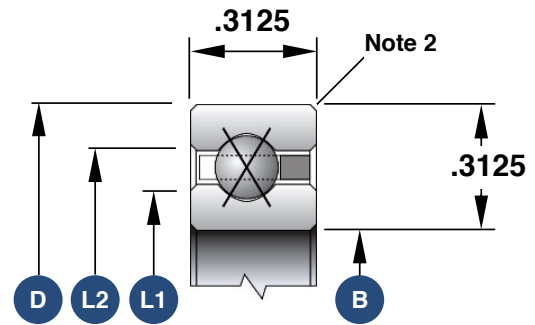

1. Load capacities are not additive
2. The maximum shaft or housing fillet radius that the bearing corners will clear for this series is 0.040"
3. Race Width Tolerance: +0.000 -0.005"

Also Available

Open Angular Contact	SB035AR0
Open Radial Contact	SB035CP0
Sealed Radial Contact	JSB035CP0
Sealed 4-Point Contact	JSB035XP0
Open Duplexed (Back-to-Back)	SB035BR0
Open Duplexed (Face-to-Face)	SB035FR0