

SILVERTHIN SB040AR0**4 in Open Type A Thin Section Bearing****Specifications**

Bore (B)	4.000 in
Outside Diameter (D)	4.625 in
Width	5/16"
Land Diameter (L ₁)	4.231 in
Land Diameter (L ₂)	4.393 in
Land Diameter (L ₃)	4.460 in
Approximate Weight	0.30 lbs
Separator	Brass; one piece pocket separator
Precision Class	ABEC Class 1
Bearing Type	Angular Contact (Type A)
Seals, Shields	None (Open)
Unit System	Inch

Load Capacities

Static Radial Load	2,040 lbf
Dynamic Radial Load	865 lbf
Static Thrust Load	5,890 lbf
Dynamic Thrust Load	2,100 lbf

Interchange

Silverthin	SB040AR0	Kaydon	KB040AR0
SKF	FPAB400	FAG	L15RA400
SSB	RB040AR0	RBC	KB040AR0*RBC

Brass; one piece pocket separator

5/32" balls

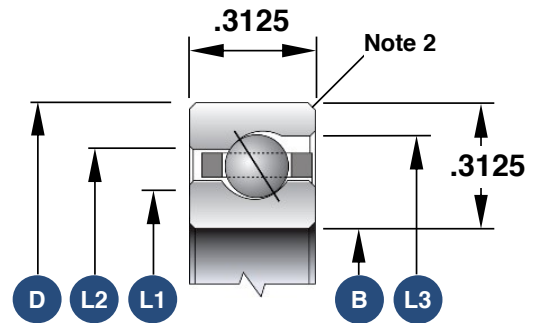

1. Load capacities are not additive
2. The maximum shaft or housing fillet radius that the bearing corners will clear for this series is 0.040"
3. Race Width Tolerance: +0.000 -0.005"

Also Available

Open Radial Contact	SB040CP0
Open 4-Point Contact	SB040XP0
Sealed Radial Contact	JSB040CP0
Sealed 4-Point Contact	JSB040XP0
Open Duplexed (Back-to-Back)	SB040BR0
Open Duplexed (Face-to-Face)	SB040FR0