

SILVERTHIN SB040CP0**4 in Open Type C Thin Section Bearing****Specifications**

Bore (B)	4.000 in
Outside Diameter (D)	4.625 in
Width	5/16"
Land Diameter (L ₁)	4.231 in
Land Diameter (L ₂)	4.393 in
Approximate Weight	0.30 lbs
Separator	Brass; snapover separator
Precision Class	ABEC Class 1
Bearing Type	Radial Contact (Type C)
Seals, Shields	None (Open)
Unit System	Inch

Load Capacities

Static Radial Load	1,750 lbf
Dynamic Radial Load	825 lbf

Interchange

Silverthin	SB040CP0	Kaydon	KB040CP0	Kaydon	KB040CP0	INA	CSCB040
SKF	FPCB400	FAG	L10RA400	NSK	NBC10107	NTN	KRB040
SSB	RB040CP0	RBC	KB040CP0*RBC				

Brass; snapover separator

5/32" balls

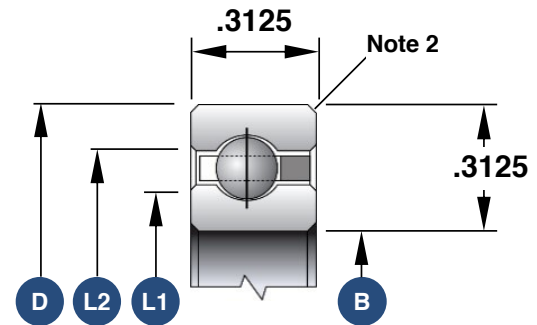

1. Load capacities are not additive
2. The maximum shaft or housing fillet radius that the bearing corners will clear for this series is 0.040"
3. Race Width Tolerance: +0.000 -0.005"

Also Available

Open Angular Contact	SB040AR0
Open 4-Point Contact	SB040XP0
Sealed Radial Contact	JSB040CP0
Sealed 4-Point Contact	JSB040XP0
Open Duplexed (Back-to-Back)	SB040BR0
Open Duplexed (Face-to-Face)	SB040FR0