

SILVERTHIN SB040XP0**4 in Open Type X Thin Section Bearing****Specifications**

Bore (B)	4.000 in
Outside Diameter (D)	4.625 in
Width	5/16"
Land Diameter (L ₁)	4.231 in
Land Diameter (L ₂)	4.393 in
Approximate Weight	0.30 lbs
Separator	Brass; snapover separator
Precision Class	ABEC Class 1
Bearing Type	4-Point Contact (Type X)
Seals, Shields	None (Open)
Unit System	Inch

Load Capacities

Static Radial Load	1,750 lbf
Dynamic Radial Load	1,090 lbf
Static Thrust Load	4,370 lbf
Dynamic Thrust Load	1,720 lbf
Static Moment Load	3,770 in-lbs
Dynamic Moment Load	1,765 in-lbs

Interchange

Silverthin	SB040XP0	Kaydon	KB040XP0	Kaydon	KB040XP0	INA	CSXB040
SKF	FPXB400	FAG	L18RA400	NSK	NBX10107	NTN	KXB040
SSB	RB040XP0	RBC	KB040XP0*RBC				

Brass; snapover separator

5/32" balls

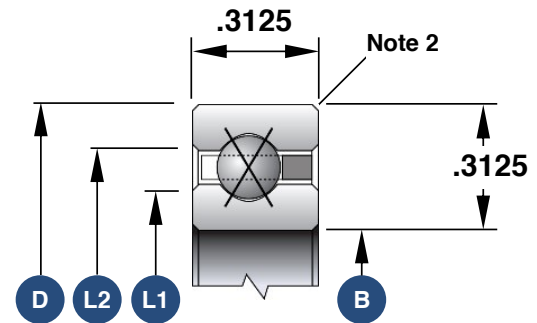

1. Load capacities are not additive
2. The maximum shaft or housing fillet radius that the bearing corners will clear for this series is 0.040"
3. Race Width Tolerance: +0.000 -0.005"

Also Available

Open Angular Contact	SB040AR0
Open Radial Contact	SB040CP0
Sealed Radial Contact	JSB040CP0
Sealed 4-Point Contact	JSB040XP0
Open Duplexed (Back-to-Back)	SB040BR0
Open Duplexed (Face-to-Face)	SB040FR0