

SILVERTHIN SB042AR0**4.25 in Open Type A Thin Section Bearing****Specifications**

Bore (B)	4.250 in
Outside Diameter (D)	4.875 in
Width	5/16"
Land Diameter (L ₁)	4.481 in
Land Diameter (L ₂)	4.643 in
Land Diameter (L ₃)	4.710 in
Approximate Weight	0.31 lbs
Separator	Brass; one piece pocket separator
Precision Class	ABEC Class 1
Bearing Type	Angular Contact (Type A)
Seals, Shields	None (Open)
Unit System	Inch

Load Capacities

Static Radial Load	2,150 lbf
Dynamic Radial Load	890 lbf
Static Thrust Load	6,200 lbf
Dynamic Thrust Load	2,170 lbf

Interchange

Silverthin	SB042AR0	Kaydon	KB042AR0	Kaydon	KB042AR0	INA	CSEB042
SKF	FPAB404	FAG	L15RA404	NSK	NBA10707	NTN	KYB042
SSB	RB042AR0	RBC	KB042AR0*RBC				

Brass; one piece pocket separator

5/32" balls

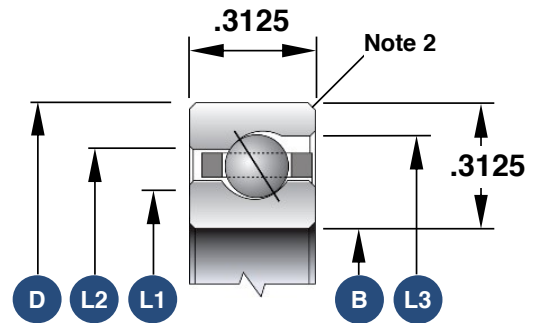

1. Load capacities are not additive
2. The maximum shaft or housing fillet radius that the bearing corners will clear for this series is 0.040"
3. Race Width Tolerance: +0.000 -0.005"

Also Available

Open Radial Contact	SB042CP0
Open 4-Point Contact	SB042XP0
Sealed Radial Contact	JSB042CP0
Sealed 4-Point Contact	JSB042XP0
Open Duplexed (Back-to-Back)	SB042BR0
Open Duplexed (Face-to-Face)	SB042FR0