

SILVERTHIN SB042CP0**4.25 in Open Type C Thin Section Bearing****Specifications**

Bore (B)	4.250 in
Outside Diameter (D)	4.875 in
Width	5/16"
Land Diameter (L ₁)	4.481 in
Land Diameter (L ₂)	4.643 in
Approximate Weight	0.31 lbs
Separator	Brass; snapover separator
Precision Class	ABEC Class 1
Bearing Type	Radial Contact (Type C)
Seals, Shields	None (Open)
Unit System	Inch

Load Capacities

Static Radial Load	1,830 lbf
Dynamic Radial Load	845 lbf

Interchange

Silverthin	SB042CP0	Kaydon	KB042CP0	Kaydon	KB042CP0	INA	CSCB042
SKF	FPCB404	FAG	L10RA404	NSK	NBC10707	NTN	KRB042
SSB	RB042CP0	RBC	KB042CP0*RBC				

Brass; snapover separator

5/32" balls

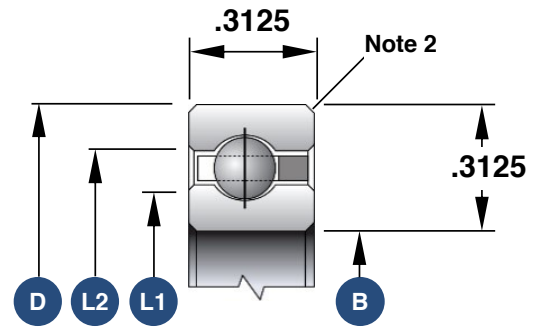

1. Load capacities are not additive
2. The maximum shaft or housing fillet radius that the bearing corners will clear for this series is 0.040"
3. Race Width Tolerance: +0.000 -0.005"

Also Available

Open Angular Contact	SB042AR0
Open 4-Point Contact	SB042XP0
Sealed Radial Contact	JSB042CP0
Sealed 4-Point Contact	JSB042XP0
Open Duplexed (Back-to-Back)	SB042BR0
Open Duplexed (Face-to-Face)	SB042FR0