

SILVERTHIN SB042XP0**4.25 in Open Type X Thin Section Bearing****Specifications**

Bore (B)	4.250 in
Outside Diameter (D)	4.875 in
Width	5/16"
Land Diameter (L ₁)	4.481 in
Land Diameter (L ₂)	4.643 in
Approximate Weight	0.31 lbs
Separator	Brass; snapover separator
Precision Class	ABEC Class 1
Bearing Type	4-Point Contact (Type X)
Seals, Shields	None (Open)
Unit System	Inch

Load Capacities

Static Radial Load	1,830 lbf
Dynamic Radial Load	1,120 lbf
Static Thrust Load	4,570 lbf
Dynamic Thrust Load	1,780 lbf
Static Moment Load	4,170 in-lbs
Dynamic Moment Load	1,915 in-lbs

Interchange

Silverthin	SB042XP0	Kaydon	KB042XP0
SKF	FPXB404	FAG	L18RA404
SSB	RB042XP0	RBC	KB042XP0*RBC

Brass; snapover separator

5/32" balls

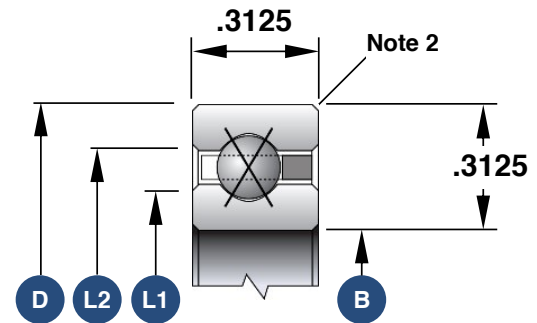

1. Load capacities are not additive
2. The maximum shaft or housing fillet radius that the bearing corners will clear for this series is 0.040"
3. Race Width Tolerance: +0.000 -0.005"

Also Available

Open Angular Contact	SB042AR0
Open Radial Contact	SB042CP0
Sealed Radial Contact	JSB042CP0
Sealed 4-Point Contact	JSB042XP0
Open Duplexed (Back-to-Back)	SB042BR0
Open Duplexed (Face-to-Face)	SB042FR0