

**SILVERTHIN SB045ARO****4.5 in Open Type A Thin Section Bearing****Specifications**

Bore (B)	4.500 in
Outside Diameter (D)	5.125 in
Width	5/16"
Land Diameter (L <sub>1</sub> )	4.731 in
Land Diameter (L <sub>2</sub> )	4.893 in
Land Diameter (L <sub>3</sub> )	4.960 in
Approximate Weight	0.33 lbs
Separator	Brass; one piece pocket separator
Precision Class	ABEC Class 1
Bearing Type	Angular Contact (Type A)
Seals, Shields	None (Open)
Unit System	Inch

**Load Capacities**

Static Radial Load	2,250 lbf
Dynamic Radial Load	915 lbf
Static Thrust Load	6,500 lbf
Dynamic Thrust Load	2,240 lbf

**Interchange**

Silverthin	<b>SB045ARO</b>	Kaydon	<b>KB045ARO</b>	Kaydon	<b>KB045ARO</b>	INA	<b>CSEB045</b>
SKF	<b>FPAB408</b>	FAG	<b>L15RA408</b>	NSK	<b>NBA11407</b>	NTN	<b>KYB045</b>
SSB	<b>RB045ARO</b>	RBC	<b>KB045ARO*RBC</b>				

**Brass; one piece pocket separator**

5/32" balls

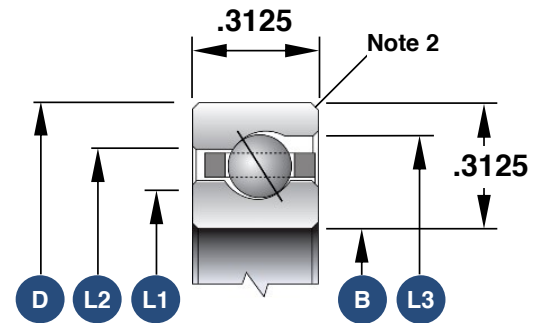

1. Load capacities are not additive
2. The maximum shaft or housing fillet radius that the bearing corners will clear for this series is 0.040"
3. Race Width Tolerance: +0.000 -0.005"

**Also Available**

Open Radial Contact	<b>SB045CP0</b>
Open 4-Point Contact	<b>SB045XP0</b>
Sealed Radial Contact	<b>JSB045CP0</b>
Sealed 4-Point Contact	<b>JSB045XP0</b>
Open Duplexed (Back-to-Back)	<b>SB045BR0</b>
Open Duplexed (Face-to-Face)	<b>SB045FR0</b>