

SILVERTHIN SB045CP0**4.5 in Open Type C Thin Section Bearing****Specifications**

Bore (B)	4.500 in
Outside Diameter (D)	5.125 in
Width	5/16"
Land Diameter (L ₁)	4.731 in
Land Diameter (L ₂)	4.893 in
Approximate Weight	0.33 lbs
Separator	Brass; snapover separator
Precision Class	ABEC Class 1
Bearing Type	Radial Contact (Type C)
Seals, Shields	None (Open)
Unit System	Inch

Load Capacities

Static Radial Load	1,950 lbf
Dynamic Radial Load	880 lbf

Interchange

Silverthin	SB045CP0	Kaydon	KB045CP0	Kaydon	KB045CP0	INA	CSCB045
SKF	FPCB408	FAG	L10RA408	NSK	NBC11407	NTN	KRB045
SSB	RB045CP0	RBC	KB045CP0*RBC				

Brass; snapover separator

5/32" balls

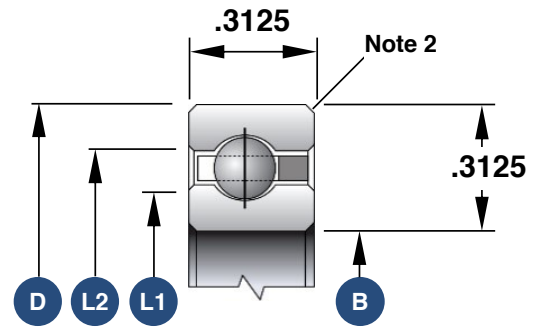

1. Load capacities are not additive
2. The maximum shaft or housing fillet radius that the bearing corners will clear for this series is 0.040"
3. Race Width Tolerance: +0.000 -0.005"

Also Available

Open Angular Contact	SB045AR0
Open 4-Point Contact	SB045XP0
Sealed Radial Contact	JSB045CP0
Sealed 4-Point Contact	JSB045XP0
Open Duplexed (Back-to-Back)	SB045BR0
Open Duplexed (Face-to-Face)	SB045FR0