

SILVERTHIN SB045XP0**4.5 in Open Type X Thin Section Bearing****Specifications**

Bore (B)	4.500 in
Outside Diameter (D)	5.125 in
Width	5/16"
Land Diameter (L ₁)	4.731 in
Land Diameter (L ₂)	4.893 in
Approximate Weight	0.33 lbs
Separator	Brass; snapover separator
Precision Class	ABEC Class 1
Bearing Type	4-Point Contact (Type X)
Seals, Shields	None (Open)
Unit System	Inch

Load Capacities

Static Radial Load	1,950 lbf
Dynamic Radial Load	1,165 lbf
Static Thrust Load	4,880 lbf
Dynamic Thrust Load	1,850 lbf
Static Moment Load	4,690 in-lbs
Dynamic Moment Load	2,105 in-lbs

Interchange

Silverthin	SB045XP0	Kaydon	KB045XP0	Kaydon	KB045XP0	INA	CSXB045
SKF	FPXB408	FAG	L18RA408	NSK	NBX11407	NTN	KXB045
SSB	RB045XP0	RBC	KB045XP0*RBC				

Brass; snapover separator

5/32" balls

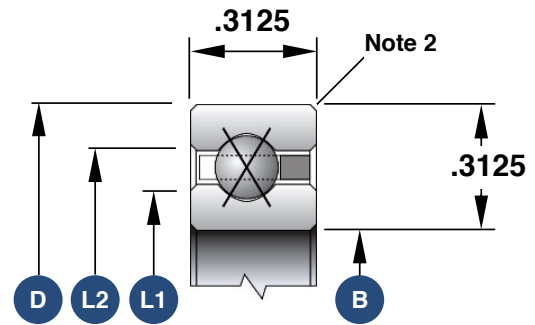

1. Load capacities are not additive
2. The maximum shaft or housing fillet radius that the bearing corners will clear for this series is 0.040"
3. Race Width Tolerance: +0.000 -0.005"

Also Available

Open Angular Contact	SB045AR0
Open Radial Contact	SB045CP0
Sealed Radial Contact	JSB045CP0
Sealed 4-Point Contact	JSB045XP0
Open Duplexed (Back-to-Back)	SB045BR0
Open Duplexed (Face-to-Face)	SB045FR0