

SILVERTHIN SB047AR0**4.75 in Open Type A Thin Section Bearing****Specifications**

Bore (B)	4.750 in
Outside Diameter (D)	5.375 in
Width	5/16"
Land Diameter (L ₁)	4.981 in
Land Diameter (L ₂)	5.143 in
Land Diameter (L ₃)	5.210 in
Approximate Weight	0.34 lbs
Separator	Brass; one piece pocket separator
Precision Class	ABEC Class 1
Bearing Type	Angular Contact (Type A)
Seals, Shields	None (Open)
Unit System	Inch

Load Capacities

Static Radial Load	2,390 lbf
Dynamic Radial Load	950 lbf
Static Thrust Load	6,910 lbf
Dynamic Thrust Load	2,340 lbf

Interchange

Silverthin	SB047AR0	Kaydon	KB047AR0	Kaydon	KB047AR0	INA	CSEB047
SKF	FPAB412	FAG	L15RA412	NSK	NBA12007	NTN	KYB047
SSB	RB047AR0	RBC	KB047AR0*RBC				

Brass; one piece pocket separator

5/32" balls

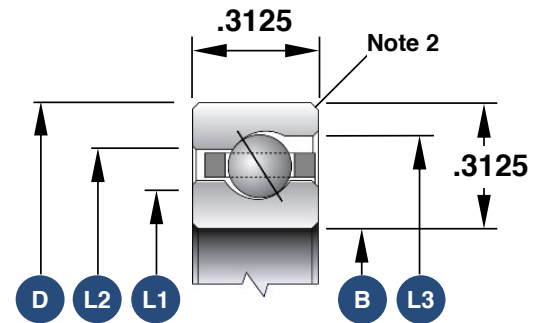

1. Load capacities are not additive
2. The maximum shaft or housing fillet radius that the bearing corners will clear for this series is 0.040"
3. Race Width Tolerance: +0.000 -0.005"

Also Available

Open Radial Contact	SB047CP0
Open 4-Point Contact	SB047XP0
Sealed Radial Contact	JSB047CP0
Sealed 4-Point Contact	JSB047XP0
Open Duplexed (Back-to-Back)	SB047BR0
Open Duplexed (Face-to-Face)	SB047FR0