

SILVERTHIN SB047CP0**4.75 in Open Type C Thin Section Bearing****Specifications**

Bore (B)	4.750 in
Outside Diameter (D)	5.375 in
Width	5/16"
Land Diameter (L ₁)	4.981 in
Land Diameter (L ₂)	5.143 in
Approximate Weight	0.34 lbs
Separator	Brass; snapover separator
Precision Class	ABEC Class 1
Bearing Type	Radial Contact (Type C)
Seals, Shields	None (Open)
Unit System	Inch

Load Capacities

Static Radial Load	2,030 lbf
Dynamic Radial Load	900 lbf

Interchange

Silverthin	SB047CP0	Kaydon	KB047CP0	Kaydon	KB047CP0	INA	CSCB047
SKF	FPCB412	FAG	L10RA412	NSK	NBC12007	NTN	KRB047
SSB	RB047CP0	RBC	KB047CP0*RBC				

Brass; snapover separator

5/32" balls

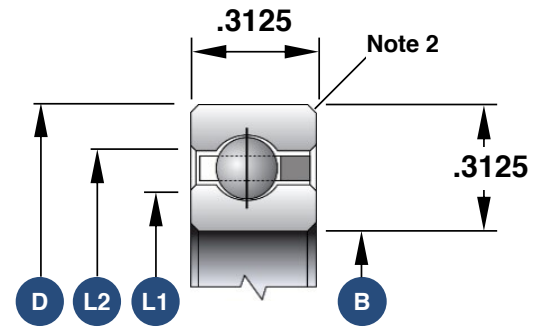

1. Load capacities are not additive
2. The maximum shaft or housing fillet radius that the bearing corners will clear for this series is 0.040"
3. Race Width Tolerance: +0.000 -0.005"

Also Available

Open Angular Contact	SB047AR0
Open 4-Point Contact	SB047XP0
Sealed Radial Contact	JSB047CP0
Sealed 4-Point Contact	JSB047XP0
Open Duplexed (Back-to-Back)	SB047BR0
Open Duplexed (Face-to-Face)	SB047FR0