

SILVERTHIN SB047XP0**4.75 in Open Type X Thin Section Bearing****Specifications**

Bore (B)	4.750 in
Outside Diameter (D)	5.375 in
Width	5/16"
Land Diameter (L ₁)	4.981 in
Land Diameter (L ₂)	5.143 in
Approximate Weight	0.34 lbs
Separator	Brass; snapover separator
Precision Class	ABEC Class 1
Bearing Type	4-Point Contact (Type X)
Seals, Shields	None (Open)
Unit System	Inch

Load Capacities

Static Radial Load	2,030 lbf
Dynamic Radial Load	1,195 lbf
Static Thrust Load	5,080 lbf
Dynamic Thrust Load	1,900 lbf
Static Moment Load	5,140 in-lbs
Dynamic Moment Load	2,265 in-lbs

Interchange

Silverthin	SB047XP0	Kaydon	KB047XP0	Kaydon	KB047XP0	INA	CSXB047
SKF	FPXB412	FAG	L18RA412	NSK	NBX12007	NTN	KXB047
SSB	RB047XP0	RBC	KB047XP0*RBC				

Brass; snapover separator

5/32" balls

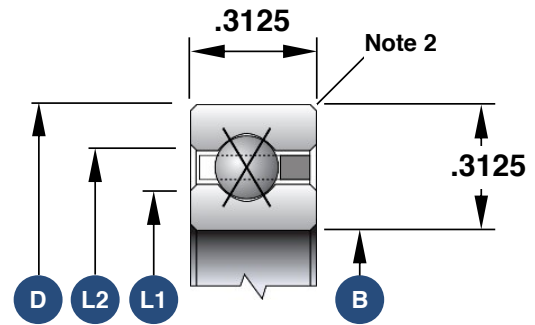

1. Load capacities are not additive
2. The maximum shaft or housing fillet radius that the bearing corners will clear for this series is 0.040"
3. Race Width Tolerance: +0.000 -0.005"

Also Available

Open Angular Contact	SB047AR0
Open Radial Contact	SB047CP0
Sealed Radial Contact	JSB047CP0
Sealed 4-Point Contact	JSB047XP0
Open Duplexed (Back-to-Back)	SB047BR0
Open Duplexed (Face-to-Face)	SB047FR0