

**SILVERTHIN SB050AR0****5 in Open Type A Thin Section Bearing****Specifications**

Bore (B)	5.000 in
Outside Diameter (D)	5.625 in
Width	5/16"
Land Diameter (L <sub>1</sub> )	5.231 in
Land Diameter (L <sub>2</sub> )	5.393 in
Land Diameter (L <sub>3</sub> )	5.460 in
Approximate Weight	0.38 lbs
Separator	Brass; one piece pocket separator
Precision Class	ABEC Class 1
Bearing Type	Angular Contact (Type A)
Seals, Shields	None (Open)
Unit System	Inch

**Load Capacities**

Static Radial Load	2,500 lbf
Dynamic Radial Load	975 lbf
Static Thrust Load	7,210 lbf
Dynamic Thrust Load	2,410 lbf

**Interchange**

Silverthin	<a href="#">SB050AR0</a>	Kaydon	<a href="#">KB050AR0</a>	Kaydon	<a href="#">KB050AR0</a>	INA	<a href="#">CSEB050</a>
SKF	<a href="#">FPAB500</a>	FAG	<a href="#">L15RA500</a>	NSK	<a href="#">NBA12707</a>	NTN	<a href="#">KYB050</a>
SSB	<a href="#">RB050AR0</a>	RBC	<a href="#">KB050AR0*RBC</a>				

**Brass; one piece pocket separator**

5/32" balls

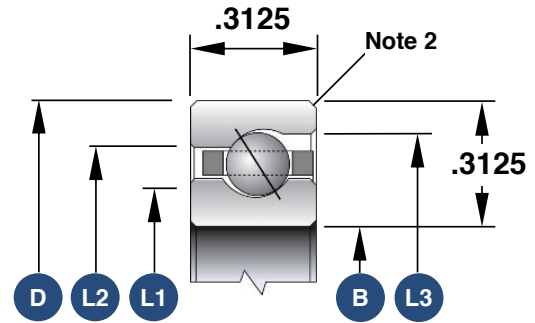

1. Load capacities are not additive
2. The maximum shaft or housing fillet radius that the bearing corners will clear for this series is 0.040"
3. Race Width Tolerance: +0.000 -0.005"

**Also Available**

Open Radial Contact	<a href="#">SB050CP0</a>
Open 4-Point Contact	<a href="#">SB050XP0</a>
Sealed Radial Contact	<a href="#">JSB050CP0</a>
Sealed 4-Point Contact	<a href="#">JSB050XP0</a>
Open Duplexed (Back-to-Back)	<a href="#">SB050BR0</a>
Open Duplexed (Face-to-Face)	<a href="#">SB050FR0</a>