

SILVERTHIN SB050CP0**5 in Open Type C Thin Section Bearing****Specifications**

Bore (B)	5.000 in
Outside Diameter (D)	5.625 in
Width	5/16"
Land Diameter (L ₁)	5.231 in
Land Diameter (L ₂)	5.393 in
Approximate Weight	0.38 lbs
Separator	Brass; snapover separator
Precision Class	ABEC Class 1
Bearing Type	Radial Contact (Type C)
Seals, Shields	None (Open)
Unit System	Inch

Load Capacities

Static Radial Load	2,150 lbf
Dynamic Radial Load	935 lbf

Interchange

Silverthin	SB050CP0	Kaydon	KB050CP0	Kaydon	KB050CP0	INA	CSCB050
SKF	FPCB500	FAG	L10RA500	NSK	NBC12707	NTN	KRB050
SSB	RB050CP0	RBC	KB050CP0*RBC				

Brass; snapover separator

5/32" balls

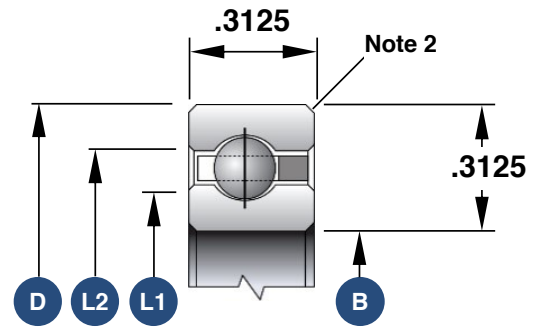

1. Load capacities are not additive
2. The maximum shaft or housing fillet radius that the bearing corners will clear for this series is 0.040"
3. Race Width Tolerance: +0.000 -0.005"

Also Available

Open Angular Contact	SB050AR0
Open 4-Point Contact	SB050XP0
Sealed Radial Contact	JSB050CP0
Sealed 4-Point Contact	JSB050XP0
Open Duplexed (Back-to-Back)	SB050BR0
Open Duplexed (Face-to-Face)	SB050FR0